

EXISTING	FUTURE	ITEM
---	---	Airport Property Line
---	---	Utility Pole Line
---	---	Security Fence
---	---	Airfield Pavement
---	---	Non - Airfield Pavement
---	---	Pavement to be removed
---	---	Buildings
---	---	Residential Buildings
---	---	Buildings To Be Removed
---	---	Railroad
---	---	Windcone
---	---	Airport Reference Point
---	---	NAVAIDS
---	---	Rotating Beacon El. 938.6
---	---	Wooded Area
---	---	Helipad
---	---	RSA
---	---	OFA
---	---	Avigation Easement
---	---	Equipment Critical Area
---	---	Runway Centerline

Notes:
The proposed development shown in this area is conceptual in nature and subject to change based upon actual demand.

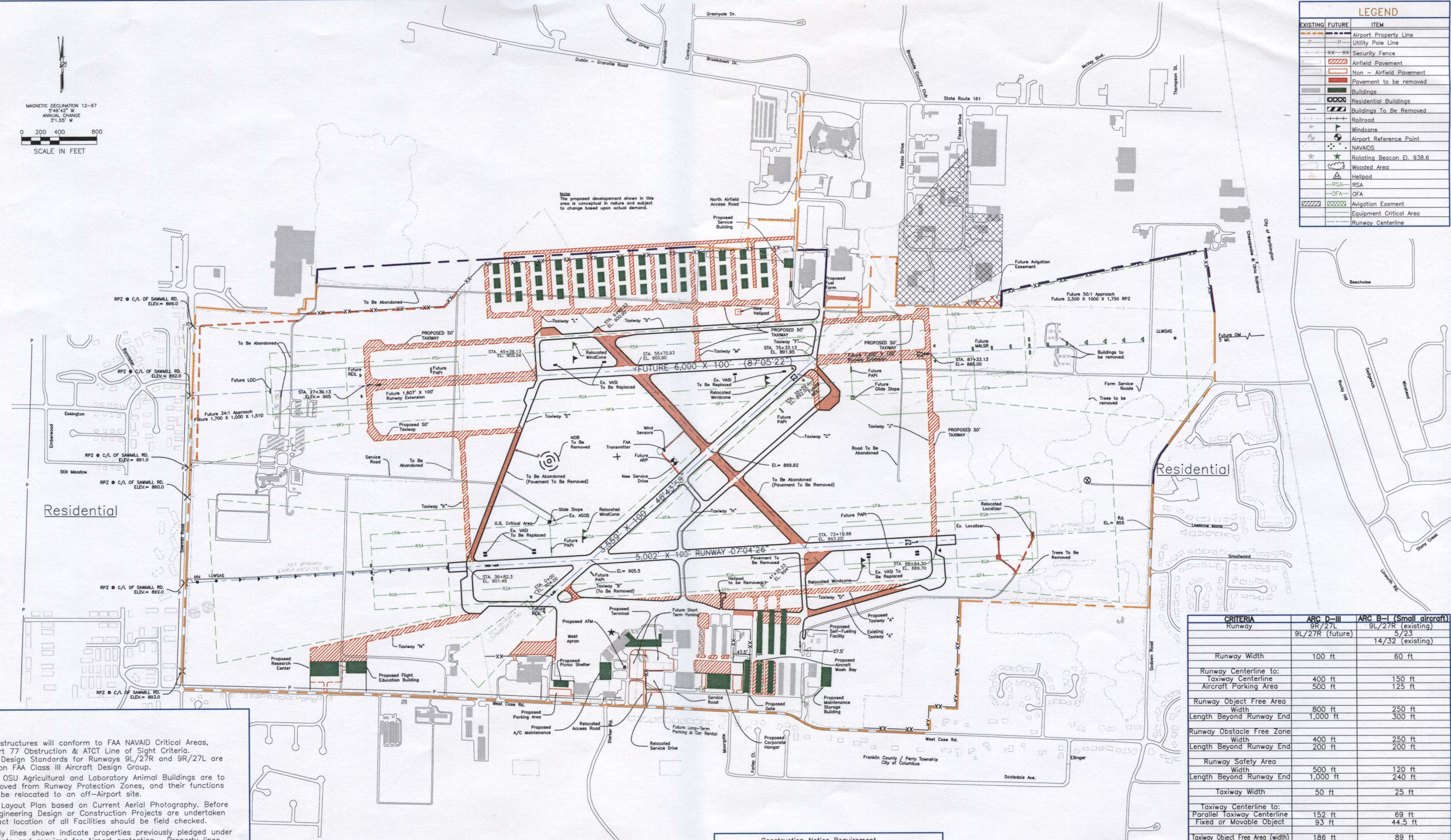

- Notes:
- Future structures will conform to FAA NAVAID Critical Areas, FAA Part 77 Obstruction & ATCT Line of Sight Criteria.
 - Airport Design Standards for Runways 9L/27R and 9R/27L are based on FAA Class III Aircraft Design Group.
 - Certain OSU Agricultural and Laboratory Animal Buildings are to be removed from Runway Protection Zones, and their functions are to be relocated to an off-Airport site.
 - Airport Layout Plan based on Current Aerial Photography. Before any Engineering Design or Construction Projects are undertaken the exact location of all Facilities should be field checked.
 - Property lines shown indicate properties previously pledged under FAA grants and required for Airport protection. Property lines may be altered subject to future negotiations between the sponsor and FAA.
 - All University owned land beyond that required for Airport purposes will require Avigation Easements and assurances of land use compatibility before release from FAA Grant Assurances.

CRITERIA	ARC D-III 9R/27L	ARC B-1 (Small aircraft) 9L/27R (existing)
Runway	9R/27L 9L/27R (future)	9L/27R (existing) 5/23 14/32 (existing)
Runway Width	100 ft	60 ft
Runway Centerline to: Taxiway Centerline	400 ft	150 ft
Aircraft Parking Area	500 ft	125 ft
Runway Object Free Area Width	800 ft	250 ft
Length Beyond Runway End	1,000 ft	300 ft
Runway Obstacle Free Zone Width	400 ft	250 ft
Length Beyond Runway End	200 ft	200 ft
Runway Safety Area Width	500 ft	120 ft
Length Beyond Runway End	1,000 ft	240 ft
Taxiway Width	50 ft	25 ft
Taxiway Centerline to: Parallel Taxiway Centerline	152 ft	69 ft
Fixed or Movable Object	93 ft	44.5 ft
Taxiway Object Free Area (width)	186 ft	89 ft
Taxiway Safety Area (Width)	118 ft	49 ft
Runway Blast Pad Length	200 ft	60 ft
Width	140 ft	80 ft

Construction Notice Requirement
To protect operational safety and future development, all proposed construction on the airport must be coordinated by the airport owner with the FAA Airport District Office prior to construction. FAA's review takes approximately 60 days.



WILBUR SMITH ASSOCIATES
6600 CLOUGH PIKE
CINCINNATI, OH 45244
TEL (513)233-3700 FAX (513)624-5182

OSU CONTRACT NO.
WSA PROJECT NUMBER:
RDZ PROJECT NUMBER: 5831
DRAWN BY: P.M.
CHECKED BY: J.K.
DATE: 1/1/01

THE OHIO STATE UNIVERSITY
APPROVED _____ DATE _____
APPROVED _____ DATE _____
APPROVED _____ DATE _____

WILBUR SMITH ASSOCIATES
APPROVED _____ DATE _____
ODOT - OFFICE OF AVIATION
APPROVED _____ DATE _____
CHIEF, OFFICE OF AVIATION

NO.	DATE	REVISIONS

THE OHIO STATE UNIVERSITY AIRPORT
FUTURE AIRPORT LAYOUT PLAN
R.D. Zande & Associates, Inc.
1237 Dublin Road
Columbus, Ohio 43215
Phone: (614) 486-4383
SCALE: 1" = 400' DATE: 10/04/02